

BIGUMA® -Dreieck Band



Polymer modified meltable bitumen joint tape

Merkmale

BIGUMA®- Dreieck Band is an elastomer modified, fibre-reinforced, filled bitumen product.

BIGUMA®- Dreieck Band has got many advantages:

- easy and quick application
- adaptes also to uneven subsoil
- right after the application of the triangular tape the subsequent works can be carried out
- widely weathering and age resistant
- permanent waterproof
- flexible at cold temperatures
- high bonding property
- can be super structured without any problems i. e. by bituminous welded sheetings, bituminous moisture proof roofing sheets, or similar
- complete adhesion to the subsoil, prevents from the occurrence of water

Application instructions

a) Preparatory work

The surface must be dry, clean, and free from dust. Remove all loose debris.

b) Primer

The surface will be primed before the application of the tape with a suitable primer. For BIGUMA®- Dreieck Band the primer COLZUMIX®- VFB or COLZUMIX®- Haftgrund had been developed and form a system together with the tape. COLZUMIX®- Haftgrund is to be used there, where the subsoil shall not be coloured black. The primer will be applied by brush or sprayed.

c) Application

BIGUMA®- Dreieck Band is taken out of the carton, rolled and laid out along the joint edge and lightly melted by means of a propane gas torch or stacked by means of bitumen. The soft and sticking tape will be pressed bondingly on the primed subsoil. You have to pay attention to the fact, that both sides of the tape adhere completely to the subsoil at the edges and / or concave mouldings and that no defects appear. Together with the primer a long-lasting bonding is guaranteed.

Packaging

Tape dimensions: 25 x 25 mm / 25 x 30 mm / 30 x 30 mm / 40 x 40 mm

Supplied in cartons of approx. 15 to 18 kg or 14 to 30 m according to the tape dimension.

The tape is rolled on silicone paper, the layers are separated by silicone card so that the tape will not stick together in the carton.

Central Sales

Dortmunder Gußasphalt GmbH & Co. KG

✉ Am Hafenbahnhof 10 ■ 44147 Dortmund ■ Germany

☎ +49 231 395797 - 37 @ info@dga.de

Producer

Plant Isoliererzeugnisse Großbröhrsdorf

Storage

Cool and dry.

Stack height: max. 4 boxes

Storage life: nearly indefinite

Technical data

Product type: Polymer modified bitumen with fillers

Softening point ring and ball: > 90 °C

Cone penetration: ca. 30 1/10 mm

Shape retention: ca. 24 %

Bending deformation at 0°C: no crack when bending

Strain and bonding capability -10 °C: > 10 %

Construction and civil engineering

Formation of hollow throats between concrete ceilings and ascending masonry for subsequent application of the waterproofing, e. g.:

Foundation base

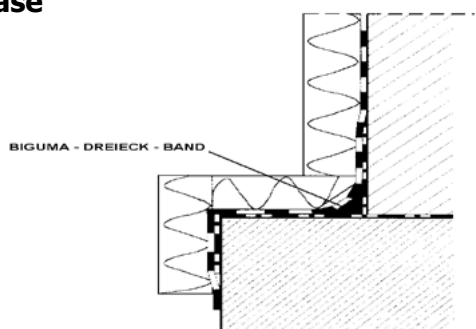

Parking deck seal

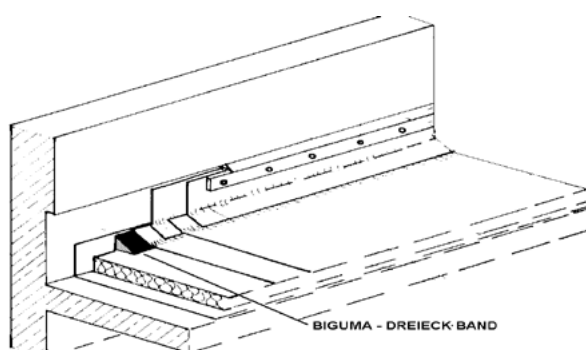

This product information corresponds to our latest available information. The processor is obliged to test the suitability and application options for the intended purpose. We shall be pleased to advise if you have any questions about our product. Our Terms and Conditions of Business apply, which can be found at www.dga.de.

Rev.: 01/19

Central Sales

Dortmunder Gußasphalt GmbH & Co. KG

✉ Am Hafenbahnhof 10 ■ 44147 Dortmund ■ Germany

☎ +49 231 395797 - 37 @ info@dga.de

Producer

Plant Isoliererzeugnisse Großbröhrsdorf